

RMC-1000/2000 DATA SHEET



The RMC Controller is a modernized, cost-effective, cellular-based, and cloud-based remote monitoring system that provides real-time alarms and data. Designed for lift and pump stations, it serves as an ideal alternative to SCADA and auto-dialers.

MANUFACTURED IN THE USA.



LIFT & PUMP STATION MONITORING CAPABILITIES

- Pump Status
- High-Level Float Alarms
- Pump Failure
- Pump Overheat
- High Pressure
- Power Fail

FEATURES

- Real-time alarms and data reporting.
- Cellular-based, offering all ISP carriers via global sim.
- Local Wi-Fi access point.
- GPS with map overview.
- Cloud-based user interface accessible through free App.
- No programming is needed.
- Compact NEMA 4X polycarbonate enclosure.
- Industrial grade electronic componentry.
- MODBUS RS485

INPUTS AND OUTPUTS

MODEL: RMC-1000

- 7 Digital Inputs
- 1 Power fail

MODEL: RMC-2000

- 7 Digital Inputs
- 4 Analog Inputs
- 2 Digital Outputs
- 1 Power Fail

ENGINEERED AND MANUFACTURED IN THE USA

All AccuDose products, including hardware, firmware, software, and server hardware, are engineered and deployed in the United States.

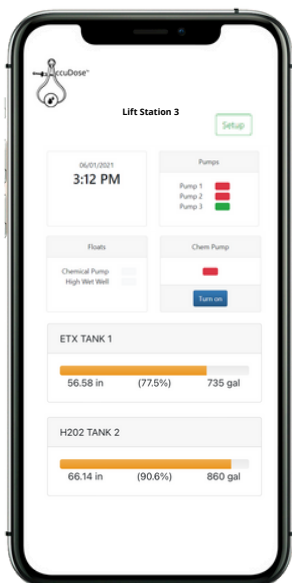
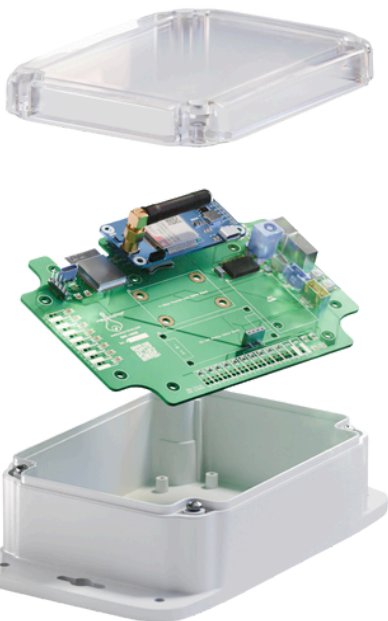

PRODUCT DIMENSIONS

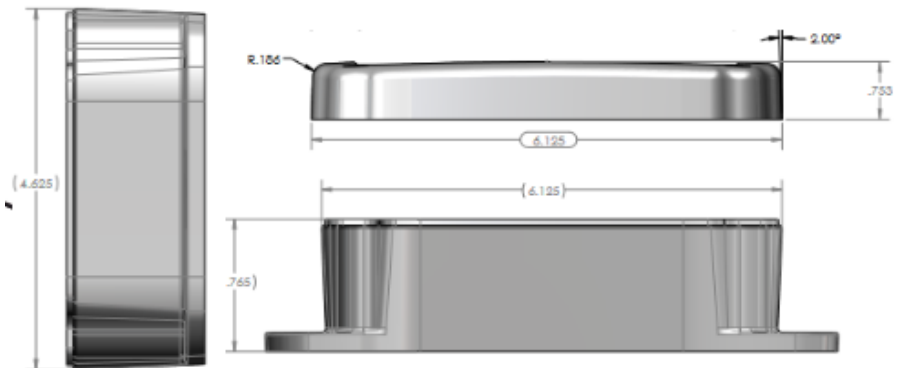
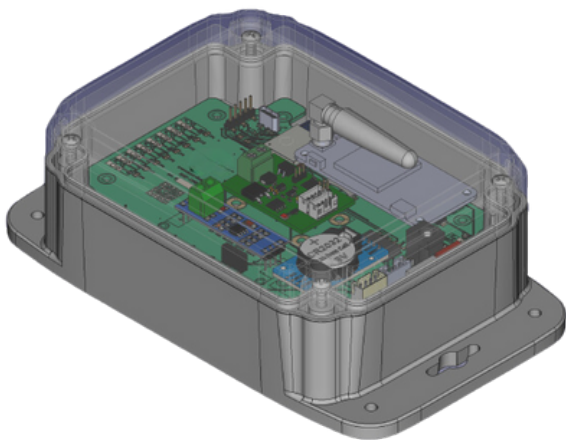

SPECIFICATIONS

Mechanical	
Base	Polycarbonate
Cover	Polycarbonate
Gasket	Continuous silicone
Assembly Screws	Stainless steel
NEMA Rating	1,2,3,3R,3RX,3X,4,4X,5,6,6P,12,13
IP Equivalent	IP65,IP66,IP67,IP68

Electrical	
Power	85...265V AC. Power consumption max. 15 Watt 24V DC + 10%. Power consumption max. 15 Watt
Environment	-20...60° C (-4...140° F)
Digital Inputs	Dry contact to ground
Digital Outputs	24VDC Open collector relay driver output
Analog Inputs	0-20ma,4-20ma,0-3.3vdc, Pulse Input