

RMC-1000 LITE



The RMC-1000Lite remote monitoring system offers an affordable, real-time solution for monitoring and alarming two pumps, one high float, and power failures. Specifically designed for small pump and grinder stations, the RMC-1000Lite leverages cutting-edge industrial-grade IIoT technology and provides free cellular internet access across most global locations. Its cost-effective design makes it ideal for deployment in both residential and commercial applications.

MANUFACTURED IN THE USA.



SMALL LIFT/GRINDER STATION MONITORING CAPABILITIES

- 2 Pump Status
- 1 High Level float
- 1 Power Fail

FEATURES

- **Includes 1 Year of cellular service.**
- Real-time alarms and data reporting.
- Cellular-based, offering all ISP carriers via global sim.
- Local Wi-Fi access point.
- GPS with map overview.
- Cloud-based user interface accessible through free App.
- No programming is needed.
- Compact NEMA 4X polycarbonate enclosure.
- Industrial grade electronic componentry.

INPUTS AND OUTPUTS

MODEL: RMC-1000Lite

- 4 Digital Inputs
- 1 Power fail

ENGINEERED AND MANUFACTURED IN THE USA

All AccuDose products, including hardware, firmware, software, and server hardware, are engineered and deployed in the United States.

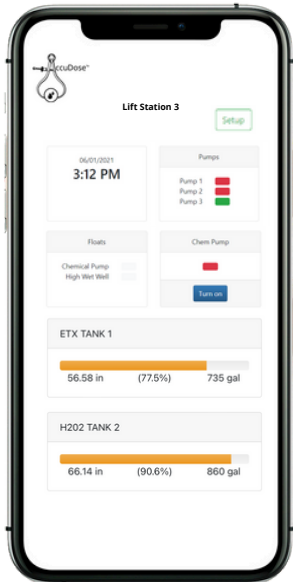

PRODUCT DIMENSIONS

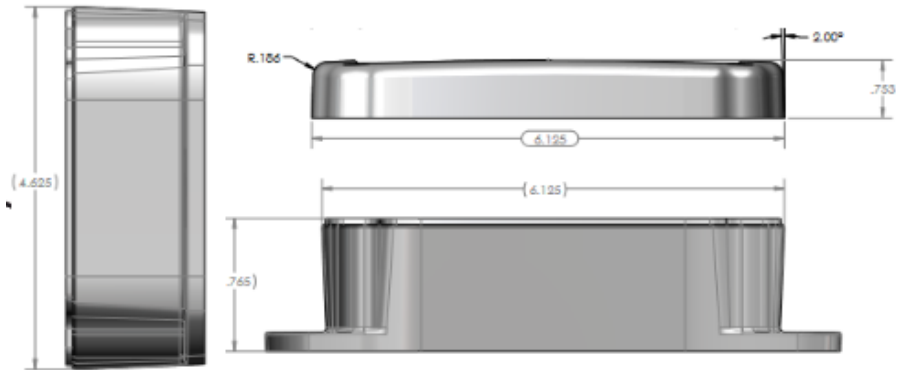
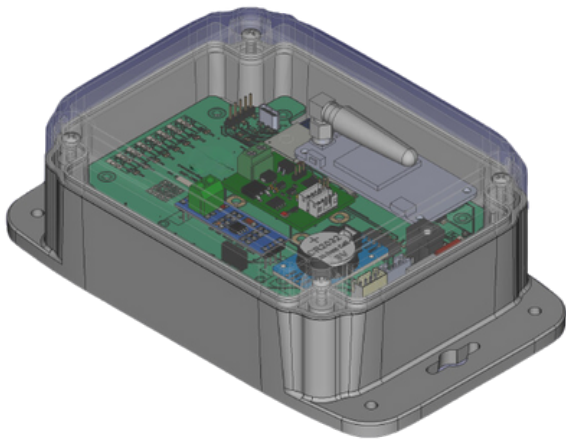

SPECIFICATIONS

Mechanical	
Base	Polycarbonate
Cover	Polycarbonate
Gasket	Continuous silicone
Assembly Screws	Stainless steel
NEMA Rating	1,2,3,3R,3RX,3X,4,4X,5,6,6P,12,13
IP Equivalent	IP65,IP66,IP67,IP68

Electrical	
Power	85...265V AC. Power consumption max. 15 Watt 24V DC + 10%. Power consumption max. 15 Watt
Environment	-20...60° C (-4...140° F)
Digital Inputs	Dry contact to ground